

# Tracks and rods installation

## Reverse pleat

**bargain**  
blinds and  
curtains

### Getting started

Being careful not to damage the track or rod; remove the packaging and check that the following parts are included:

- Curtain track or rod
- Face fixing brackets + 2 screws per bracket (number of brackets depends on the length of the track or rod)
- Bracket covers (one per bracket)
- Finials or endcaps x 2 (supplied with rods only)
- Glides attached to track or rod

#### Tools required:

- Pencil
- Tape measure
- Phillips screwdriver (track only)
- Power drill with a 3mm drill bit
- #2 square drive

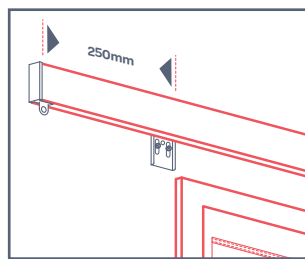
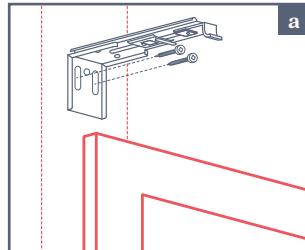

### Step 1

Find the position you originally measured from when ordering your curtains. Remember the top of your curtains should sit 5mm higher than the top of your track, or if using a rod, they will sit flush with the underside of the rod.

Ideally, if available, fix your first and last brackets into wood behind the wall lining (plasterboard) within the first 250mm of the ends of the track (a).

**Tip:** Use a stud finder to find wood.

If there is no wood within the first 250mm of track, use wall plugs and place the first and last brackets within 100mm of the ends of the track or rod.

Space the remaining brackets evenly between the first two, no more than 700mm apart.

### Fitting tracks

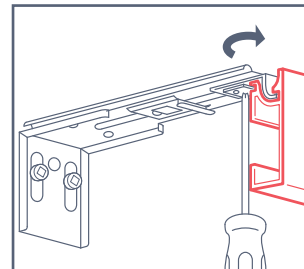
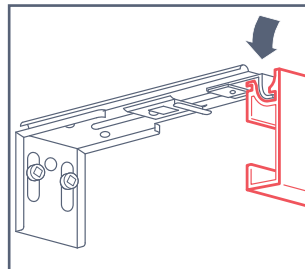

### Step 2

If fitting a track, attach it to the brackets by 'hooking' it onto the front of each bracket.

### Step 3

Lock the track in place from underneath using a Phillips screwdriver to turn the camlock counter clockwise until it stops.

### Fitting rods

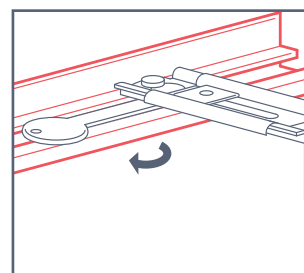
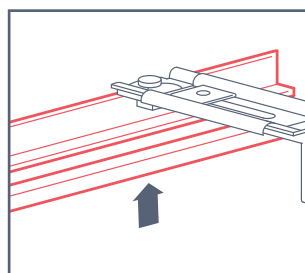

### Step 2

If fitting a rod, raise the rod to meet the underside of the brackets.

### Step 3

Fix in place from above by turning the camlock a ¼ turn on each bracket.