

# Dual roller blinds

## Outside fit

bargain  
blinds

### Getting started

Being careful not to damage the blind or chain when cutting through the packaging, unpack the blind and check all parts are included:

- 2 x slimline double brackets
- 4 x screws
- 2 x double bracket covers
- 4 x ball stops
- 2 x child safety tensioner with screw

Tools required:

- Pencil
- Tape measure
- Electric screwdriver
- #2 square drive

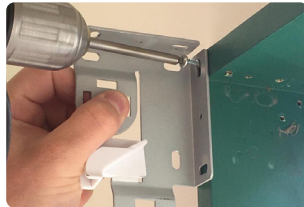

### Step 1

1 x universal end bracket  
2 x screws

At the position originally measured from, fix one universal end bracket to the architrave or wall on the left side of the window using two of the screws provided.

**Tip:** If positioning on the architrave, pre-drill the holes to prevent splitting. If fixing to the wall you may need to pack out the bracket enough to allow the blind to clear the window reveal when installed.

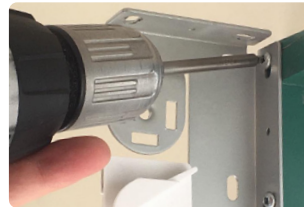

### Step 2

1 x universal end bracket  
2 x screws  
2 x bracket covers

Repeat step 2 on the right side of the window then slide the bracket covers over the brackets. This creates a neater look.

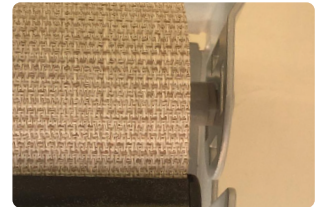

### Step 3

With clean hands, lift the back blind up to the window with the controls on the side selected when ordering.

Place the spring pin-end into the bracket first (the opposite end to the chain).



### Step 4

Applying pressure toward the pin end (to depress the pin), move the chain end of the blind into the bracket.

Pull down gently until the hooks at the end of the blind set into the bracket.



### Step 6

2 x ball stops

Attaching ball stops ensures the blind is not wound up or down too far, preventing damage.

Roll the blind to the top of its range and note the position on the chain to attach the ball stop.

Roll the blind to the bottom of its range and note the position on the chain to attach the ball stop.

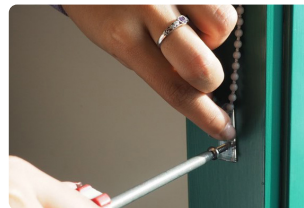

### Step 7

1 x child safety tensioner with screw

Place the tensioner over the chain and let hang to determine its position.

Using the screw provided, secure the child safety tensioner to the outside of the window frame.

**Tip:** Don't pull the chain completely tight, leave a little bit of give to make operating the blind easier.



Repeat steps 3-7 to install the front blind.

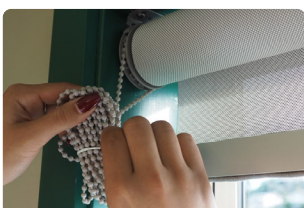

### Step 5

Remove the rubber band from the chain to operate the blind.